



Common Sound Issues: Are You Experiencing Any Of These Problems?

ABSORPTION

- Speech Intelligibility
 Reverberation
 Sound Quality
 Loudness
 Echo
 Hearing Protection

ISOLATION

- Sound Transfer
 Impact Noise
 Vibration Noise
 Low Frequencies

PROJECT SUMMARY

Absorption: Yes

Isolation: No

Install: Moderate - Difficult

Cost: \$\$ - \$\$\$

Planning Checklist

MUST KNOW

- Room Dimensions
 Ceiling Height
 New Build or Retrofit

GOOD TO KNOW

- Type of Lighting
 Ventilation/Ductwork
 Fire Suppression Systems
 Current Sound Treatments

Questions to ask an Acoustic Specialist

- *What type of solution should I consider?*
- *What kind of results can I expect from this acoustic treatment?*
- *Can I solve my problem in stages, or do I have to buy all at once?*
- *How does installation work? Do I need to buy any hanging hardware or tools separately?*
- *What questions haven't I asked yet that I should ask before making a decision?*

LEVEL OF COVERAGE

TYPICAL APPLICATIONS

Light Absorption 5% - 25% of Wall Surface Area	Appropriate for live recording or listening rooms, offices, conference rooms and rooms where people gather and converse.
Moderate Absorption 25% - 50% of Wall Surface Area	Suits listening and control rooms that typically feature more subdued music, as well as larger business spaces. Moderate absorption of around 50 percent is a good estimate for many home theaters.
Heavy Absorption 50% - 100% of Wall Surface Area	Suits drum rooms, music practice space, rooms that handle high-energy music. Vocal booths and recording isolation booths require the most absorption.



Ask yourself, What does success sound like?

Make sure you buy a solution, not a product. Your solution starts with understanding your problem and having realistic goals to attain.

TYPE OF TREATMENT NEEDED

ABSORPTION: YES

Sound absorption takes care of many sound issues at the source. Audimute's Acoustic Panels achieve results by absorbing mid and high-frequency sounds before they can scatter and distort around rooms.

ISOLATION: NO

Sound isolation addresses sound issues that bother people outside of the room in question. Isolation treatments either add mass to walls, or work as a constrained layer to transform sound. Either way, isolation (or "barrier") materials prevent sound from passing between neighboring areas.

We Recommend:

2" Thick Acoustic Panels

Why? Gallery Spaces are acoustically troublesome by nature, because they typically have hard floor and wall surfaces, and high ceilings. Acoustic Panels soften reflection of sound, removing distracting excess noise and helping to enhance the experience of a Gallery by keeping focus on the exhibits.



IF YOU CAN IMAGINE IT, THEN WE CAN CREATE IT

At Audimute we're able to make your product exclusively your own. There are virtually no limits to what can be done in your space with our products. We have the ability to custom cut, shape, print images, color coat and more with our products. If you can imagine it, then we can create it!

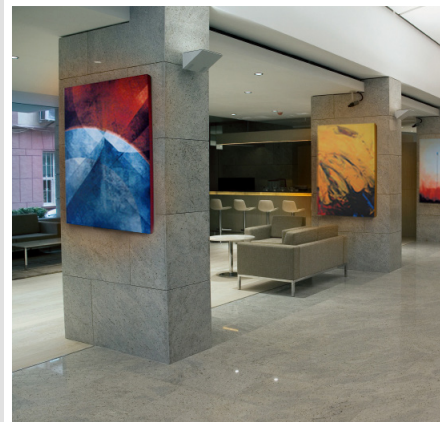

PRO TIPS: Get The Most Out of Your Sound Treatment

- Place sound absorption materials on opposite surfaces, like floor and ceiling or opposite walls, to reduce reflection between them.
- Be careful when selecting cover material to avoid distracting from the visual impact of displays.
- Place at least some absorption at levels where sound is produced.
- Consider a two phase approach: start with a low level of absorption, in anticipation of adding more later, if necessary.



TAKE THE NEXT STEP

Consult with an acoustic specialist to get personalized advice

call us at (866) 505-6883

Or, if you haven't already, fill out a room analysis form at

AudimuteAcousticPanels.com